

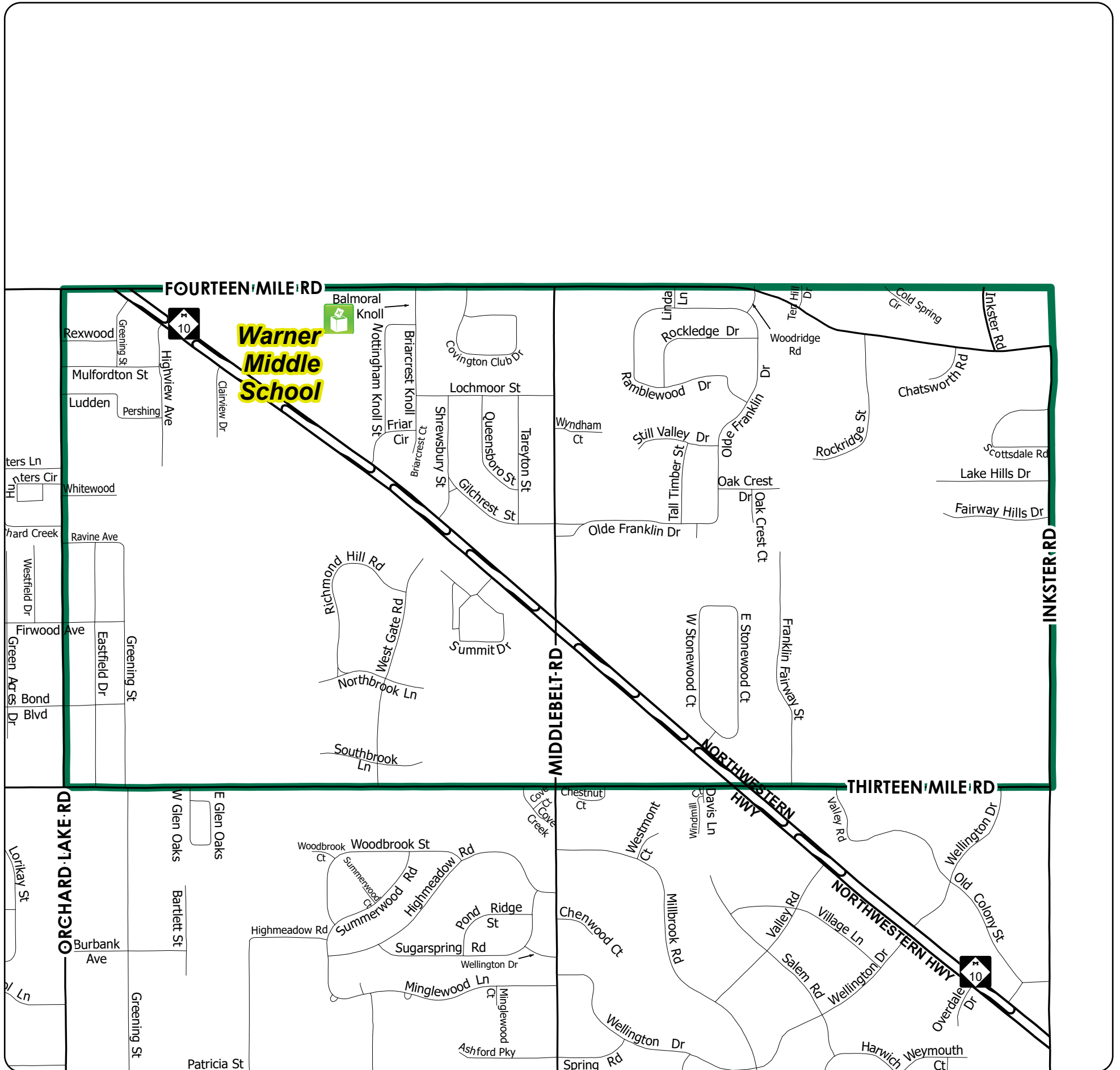

# Voting Precinct 1

## City of Farmington Hills, Michigan



### Map Legend

-  Voting Location
-  Voting Precinct Boundary

### Precinct Streets

10 HILL DR	LOCHMOOR ST	STILL VALLEY DR
W 13 MILE RD (Portion)	LUDDEN ST	E STONEWOOD CT
W 14 MILE RD (Portion)	MIDDLEBELT RD (Portion)	W STONEWOOD CT
BALMORAL KNLS	NORTHBROOK ST	STONEWOOD CT
BRIARCREST KNLS	NORTHWESTERN HWY (Portion)	SUMMIT DR
BRIARCREST CT	NOTTINGHAM KNLS	TALL TIMBER DR
CHATSWORTH ST	OAKCREST CT	TAREYTON ST
CLAIRVIEW CT	OAKCREST DR	WESTGATE RD
CLAIRVIEW DR	OLDE FRANKLIN DR	WOODRIDGE DR
COLDSRING LN	ORCHARD LAKE RD (Portion)	WYNDHAM CT
COVINGTON CLUB DR	PERSHING ST	
EASTFIELD DR	QUEENSBORO ST	
FAIRWAY HILLS DR	RAMBLEWOOD DR	
FRANKLIN FAIRWAY ST	REXWOOD ST	
FRIAR CIR	RICHMOND HL	
GILCHREST ST	ROCKLEDGE DR	
GREENING ST	ROCKRIDGE LN	
HIGHVIEW AVE	SCOTTSDALE ST	
INKSTER RD (Portion)	SHREWSBURY ST	
LAKEHILLS DR	SOUTHBROOK ST	



**SOURCES:** City of Farmington Hills GIS, 2020  
City Clerk's Office, 2020  
Oakland County GIS, 2020

**DISCLAIMER:** Although the information provided by this map is believed to be reliable, its accuracy is not warranted in any way. The City of Farmington Hills assumes no liability for any claims arising from the use of this map.

